

94ALF-A SERIES

ECONOMY FULL PORT BALL VALVE - APOLLO INTERNATIONAL™

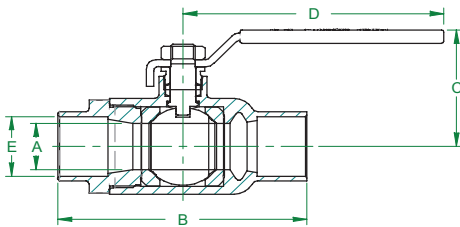
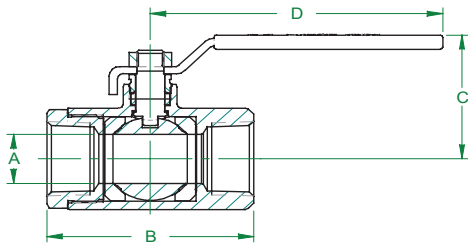

NEW/EXPANDED LEVER OPTIONS CAN BE FOUND ON PAGE B-33

These lead free ball valves with forged DZR brass body are UL listed and CSA approved. Ideal for plumbing and heating, fuel gas, fire protection and other general purpose applications.

FEATURES

- Lead Free* Materials and Certification
- EZ-Solder™ Lead Free Brass
- Solders Like Standard Brass
- Distinctive White "Lead Free" Handle Grip and Blue "Lead Free" Hang Tag
- 2-Piece, Full-Port Design
- Blowout-Proof Stem
- Adjustable Stem Packing Nut
- Multiple Agency Approvals
- MSS SP-110 - Ball Valves
- **Stem Seal O-Ring (Solder Ver. 1/2" - 2") NEW!**
- Valve Design Rating: 600 CWP - 1/4 to 2", 400 CWP - 2-1/2" to 4"
- Temperature Range: 0°F to 366°F
- 100% Factory Tested

APPROVALS

- NSF/ANSI/CAN 61 - Water Quality
- NSF/ANSI/CAN 372 - Lead Free
- IAPMO/ANSI Z1157 Ball Valves

CSA LISTED

- (File # 226234) per the following standards:
- ANSI Z21.15 (1/2 psi) (CSA 9.1) (1/4" - 2")
 - ASME B16.44 (5 psi) (CR91-002) (1/4" - 4")
 - ASME B16.33 (125 psi) (CGA 3.16) (1/4" - 2")

FM LISTED

- FM1140 Fire Protection Quick Opening Valves

UL LISTED

- UL 125 - Flow Control Valves for LP-Gas, Guide YSDT to 250 psi max
- UL 258 - Fire Protection Trim & Drain, Guide VQGU to 175psi max (1/4" - 2")
- UL 842 - Valves for Flammable Fluids, Guides YRBX, YRPV, and MHKZ to 250 psi max. (1/4" - 4" NPT only)
- UL 1477 - Compressed Gas Shutoff Valves, Guide YQNZ to 250 psi max (1/4" - 4" NPT only)

*Gas approvals apply to NPT models only

DIMENSIONS

PART NUMBER	SIZE (IN.)	DIMENSIONS (IN.)					WT. (LB.)
		A	B	C	D	E	
NPT							
94ALF-101-01A	1/4"	0.39	1.76	1.73	3.54	-	0.3
94ALF-102-01A	3/8"	0.39	1.76	1.73	3.54	-	0.3
94ALF-103-01A	1/2"	0.58	2.05	2.04	3.54	-	0.4
94ALF-104-01A	3/4"	0.75	2.36	2.26	3.78	-	0.7
94ALF-105-01A	1"	0.95	2.76	2.58	4.53	-	1.1
94ALF-106-01A	1-1/4"	1.26	3.31	3.05	4.53	-	1.6
94ALF-107-01A	1-1/2"	1.58	3.66	3.37	5.51	-	2.4
94ALF-108-01A	2"	1.97	4.18	3.70	6.30	-	3.4
94ALF-109-01A	2-1/2"	2.52	5.38	4.65	8.66	-	7.6
94ALF-100-01A	3"	2.95	6.04	4.97	8.66	-	9.3
94ALF-10A-01A	4"	3.95	7.39	6.13	11.02	-	16.9
SOLDER							
94ALF-203-01A	1/2"	0.58	2.05	1.84	3.54	0.63	0.4
94ALF-204-01A	3/4"	0.75	2.75	2.14	3.78	0.88	0.7
94ALF-205-01A	1"	0.95	3.31	2.45	4.53	1.13	1.1
94ALF-206-01A	1-1/4"	1.26	3.82	3.04	4.53	1.38	1.4
94ALF-207-01A	1-1/2"	1.58	4.43	3.17	5.51	1.63	2.2
94ALF-208-01A	2"	1.97	5.38	3.49	6.30	2.13	3.0
94ALF-209-01A	2-1/2"	2.52	6.28	4.66	8.66	2.63	6.4
94ALF-200-01A	3"	2.95	7.15	4.87	8.66	3.13	8.5
94ALF-20A-01A	4"	3.95	9.28	5.87	11.02	4.13	15.8

**94ALF-2xx-01A intended for soft solder installation using solders with melting temperature of < 500°F.