



## 90° Connectors

Zinc die-cast.  
For aluminum and steel  
Flex • AC • AC90 • MCI • MCI-A  
cable.



| CATALOG NUMBER | UPC/DCI/NAED MFG #018997 | TRADE SIZE | KO SIZE | UNIT PKG | STD PKG | DIM A | DIM B | DIM C | CABLE RANGE |
|----------------|--------------------------|------------|---------|----------|---------|-------|-------|-------|-------------|
| 85‡            | 00893                    | 3/8        | 1/2     | 50       | 500     | 1.370 | .340  | 1.800 | .370-.510   |
| 85A*           | 12510                    | 3/8        | 1/2     | 50       | 500     | 1.432 | .400  | 1.800 | .370-.510   |

\*Provided with insulated throat.

‡Also for MCI-A cable. Refer to page E-25 for cable ranges.  
Refer to chart on page E-24 for a list of cable types.

Concrete tight when taped.

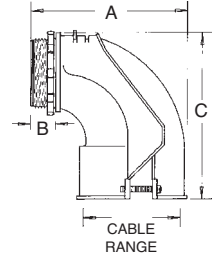

## 90° SNAP-TITE® Connectors

Zinc die-cast.  
With spring steel clip.  
For aluminum and steel  
Flex • AC • AC90 • MCI • MCI-A  
cable.



| CATALOG NUMBER | UPC/DCI/NAED MFG #018997 | TRADE SIZE | KO SIZE | UNIT PKG | STD PKG | DIM A | DIM B | DIM C | CABLE RANGE |
|----------------|--------------------------|------------|---------|----------|---------|-------|-------|-------|-------------|
| 85ST‡          | 00894                    | 3/8        | 1/2     | 50       | 500     | 1.540 | .430  | 1.800 | .370-.510   |
| 85AST*         | 12511                    | 3/8        | 1/2     | 50       | 500     | 1.600 | .490  | 1.800 | .370-.510   |

\*Provided with insulated throat.

‡Also for MCI-A cable. Refer to page E-25 for cable ranges.

Refer to chart on page E-24 for a list of cable types.

SNAP-TITE® products have been tested and listed by UL in accordance with UL's ground fault requirements. For additional information see page 6.

Concrete tight when taped.

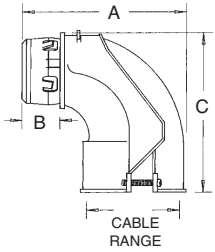

## Screw-On Snap-In Connectors

Spring steel clip with non-metallic body. Screws onto 3/8" Flex.



| CATALOG NUMBER | UPC/DCI/NAED MFG #018997 | TRADE SIZE | KO SIZE | UNIT PKG | STD PKG | DIM A | DIM B |
|----------------|--------------------------|------------|---------|----------|---------|-------|-------|
| GFSC38         | 20737                    | 3/8        | 1/2     | 50       | 500     | 1.005 | .785  |
| GFSC38B        | 20739                    | 3/8        | 1/2     | -        | 1000    | 1.005 | .785  |

For flexible metal conduit only.

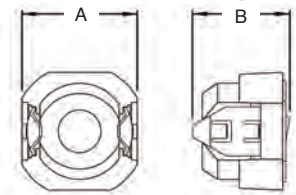

Snaps into KO with 50% less force!