

Roof Flashing

Cast aluminum. Includes set-screw(s) to secure pipe and compound.



723



726

CATALOG NUMBER	UPC/DCI/NAED MFG #018997	TRADE SIZE	STD PKG	DIM A	DIM B
723	00723	1-1/4	10	7.250	9.500
724	00724	1-1/2	10	9.000	11.000
725	00725	2	5	9.000	11.000
726	00726	1-1/4 to 2	10	7.750	15.000

UL/CSA NOT APPLICABLE

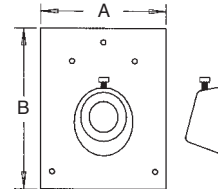

723

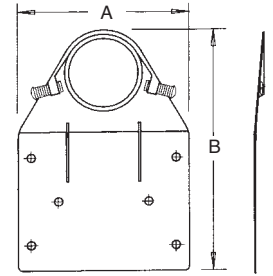

726

Mast Kits

Service entrance mast kits provide an assortment of S.E. mast components for installing overhead service drops in residential or commercial buildings using conduit.



MK200WH

CATALOG NUMBER	UPC/DCI/NAED MFG #018997	TRADE SIZE	STD PKG	ENTRANCE CAP	ROOF FLASHING	WIRE HOLDER	STRAP S	LAG BOLTS	BOTTOM REDUCER	AMPERE SERVICE
MK200	42200	2	1	145	625	-	(2) 345	(2) 3/8 X 3	650	125-150-200
MK200WH	42205	2	1	145	625	645	(2) 355	-	-	125-150-200
MK200ASF	42210	2	1	145	625	-	(2) 345	(2) 3/8 X 3	-	125-150-200
MK200PS	32044	2	1	145	625	(1) 610, (1) 620	-	-	-	125-150-200
MK250ASF	42250	2-1/2	1	129	625	-	(2) 346	(2) 1/2 X 4	651	125-150-200
MK250ASFX	42255	2-1/2	1	129	625	(2) 615, (1) 610	-	-	-	125-150-200
MK250A	32027	2-1/2	1	129	625	-	(2) 356	-	-	125-150-200