

Versions / options for stainless steel, light-duty castors

Corrosion-resistant synthetic expander fitting for round tubes

Product code suffix for the LRXA series	Product code suffix for the LKRXA series	Internal tube dimension (P) [mm]	Available for all swivel castors in the LRXA/LKRXA series with bolt hole \varnothing 11 mm. Swivel castor and expander secured to prevent loosening with positive locking. Maximum fitting length is 65 mm. Increases total height of swivel castors by 3 mm.
-EXR02	-EXR12	\varnothing 20–25	Detailed description: page 105
-EXR03	-EXR13	\varnothing 25–30	
-EXR04	-EXR14	\varnothing 30–35	
-EXR05	-EXR15	\varnothing 35–40	

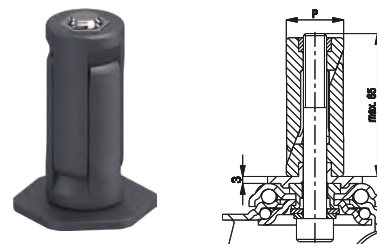

Corrosion-resistant synthetic expander fitting for square tubes

Product code suffix for the LRXA series	Product code suffix for the LKRXA series	Internal tube dimension (P) [mm]	Available for all swivel castors in the LRXA/LKRXA series with bolt hole \varnothing 11 mm. Swivel castor and expander secured to prevent loosening with positive locking. Maximum fitting length is 65 mm. Increases total height of swivel castors by 3 mm.
-EXV02	-EXV12	\square 18–21	Detailed description: page 105
-EXV03	-EXV13	\square 21–25	
-EXV04	-EXV14	\square 25–29	
-EXV05	-EXV15	\square 29–32	
-EXV07	-EXV17	\square 32–38.5	
	-EXV18	\square 35.5–41	

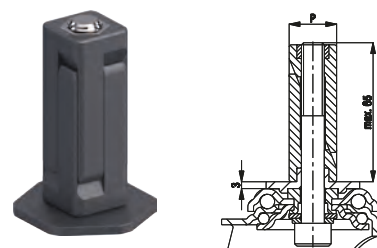

Stainless steel plug-in stem in accordance with DIN 18867-8 (large-scale catering equipment)

Product code suffix	Stem dimension (\varnothing x height) (P x Q) [mm]	\varnothing Cross hole (d) [mm]	Position cross hole (H) [mm]	Available for all swivel castors in the LKRXA-TPA and LKRXA-PATH series with wheel \varnothing 125 mm and bolt hole \varnothing 13 mm. Detailed description: page 104
-ZAX51	\varnothing 18.0 x 62	M6	30	

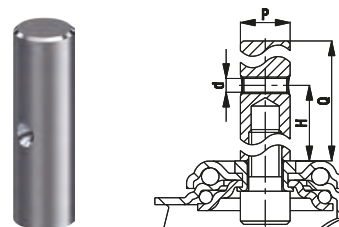

Buffers for round and square tubes

Product code	Wheel \varnothing (D) [mm]	Wheel width (T1) [mm]	Hole (d) [mm]	Buffers reduce the risk of damage to walls and vehicles in the event of a collision. Buffers for round and square tubes are fixed or connected to tubular frames in the external areas of vehicles. AG series: Made from soft synthetic polyethylene, hardness 48 Shore D, colour silver grey RAL 7001, non-marking. ARG series: Made from solid rubber, hardness 75 Shore A, colour grey, non-marking. Detailed description: page 116
Synthetic buffers (polyethylene)				
AG 100/R25	100	17.5	\varnothing 25	
AG 100/V25	100	17.5	\square 25 x 25	
AG 125/R25	125	17.5	\varnothing 25	
AG 125/V25	125	17.5	\square 25 x 25	
Solid rubber buffers				
ARG 75/R10	75	23	\varnothing 10	
ARG 100/R26	100	23	\varnothing 26	
ARG 100/R32	100	23	\varnothing 32	
ARG 125/R26	125	23	\varnothing 26	
ARG 125/R32	125	23	\varnothing 32	

Other dimensions and special colours are available upon request.

