

# Hydraulic Pressure Gauges



**CAUTION!**  
When lifting or pressing,  
always use a gauge.

Do not override factory setting of relief valves. Always use a gauge to check system pressure. A gauge is your 'window' to the system. It lets you see what's going on. See our Safety Instructions.

Page: 275

## G H Series



Pressure Range:  
**0 - 1000 bar**

Face Diameter:  
**63 - 100 mm**

Accuracy, % of full scale:  
**± 1,0 - 1,5%**

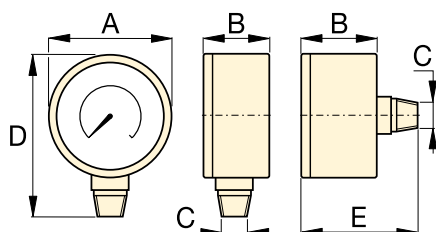

Size (mm)	Connection	Dimensions (mm)				
		A	B	C	D	E
63	Lower Mount	63	37	¼" NPTF	84	–
63	Center Rear	63	37	¼" NPTF	–	63
100	Lower Mount	100	29	¼" NPTF	121	–
100	Lower Mount	100	49	½" NPTF	136	–

Note: dimensions for reference only.



### Maximum Indicator Pointer

Indicator retains peak readings of pressure or force generated by the system.

Can easily be installed on GP and H-Series gauges. Order model number: **BSA-881**.

## ▼ SELECTION CHART

Gauge Series	Pressure Range		Model Number				Major Graduation		Minor Graduation		Major Graduation		Minor Graduation	
			ø 63 ¼" NPTF Lower Mount	ø 63 ¼" NPTF Center Rear	ø 100 ¼" NPTF Lower Mount	ø 100 ½" NPTF Lower Mount	bar		psi		bar		psi	
	(bar)	(psi)	Accuracy: ± 1,5 %		Accuracy: ± 1,0 %		ø 63	ø 100	ø 63	ø 100	ø 63	ø 100	ø 63	ø 100
G-Series	0-7	0-100	G2509L	–	–	–	1	–	0,01	–	10	–	2	–
	0-11	0-160	G2510L	–	–	–	1	–	0,02	–	10	–	2	–
	0-14	0-200	G2511L	–	–	–	1	–	0,02	–	50	–	5	–
	0-20	0-300	G2512L	–	–	–	5	–	0,50	–	50	–	5	–
	0-40	0-600	G2513L	–	–	–	10	–	1	–	100	–	10	–
	0-70	0-1.000	G2514L	G2531R	–	–	10	–	1	–	100	–	20	–
	0-140	0-2.000	G2515L	–	–	–	10	–	5	–	500	–	50	–
	0-200	0-3.000	G2516L	–	–	–	50	–	5	–	500	–	50	–
	0-400	0-6.000	G2517L	G2534R	–	–	100	–	10	–	1000	–	100	–
	0-700	0-10.000	G2535L	G2537R	G4088L	G4039L	100	100	10	10	2000	1000	200	100
0-1000	0-15.000	G2536L	G2538R	G4089L	G4040L	100	100	20	20	3000	3000	200	200	
H-Series	0-700	0-10.000	–	–	H4049L	H4071L	–	100	–	10	–	1000	–	100