

ULTIMA Steel Hand Pumps

P Series



Reservoir Capacity:
672 - 7423 cm³

Flow at Rated Pressure:
2,46 - 4,75 cm³/stroke

Maximum Operating Pressure:
700 bar

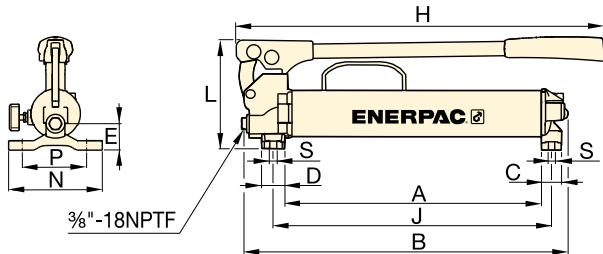

P-39, P-77

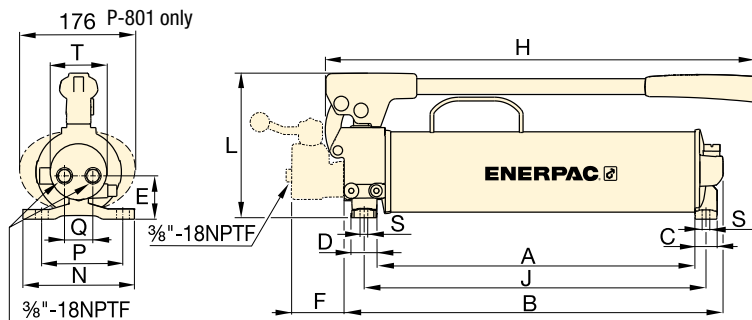

P-80, P-801, P-84

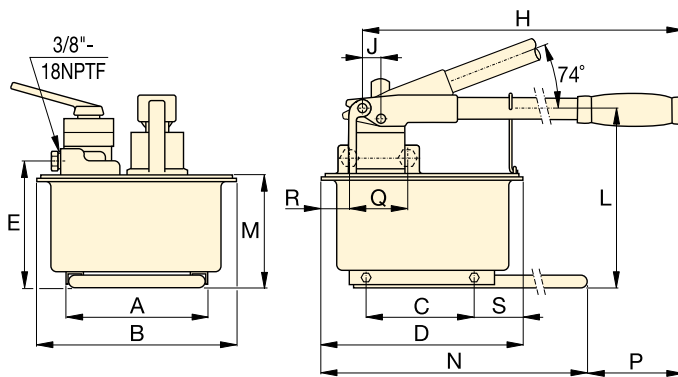

P-462, P-464



Extra Capacity Hand Pumps
P-462 and P-464 feature extra large reservoirs and high first-stage flow rate. These pumps are ideally suited for powering high-capacity cylinders.

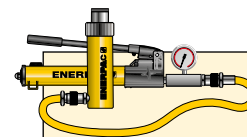

Pump-Cylinder Sets
The P-80 is also available as set (pump, cylinder, gauge, couplers and hose) for your ordering convenience.

Page: **56**



Cylinder Matching Chart

For help in selecting the correct hand pump for your application, please refer to the Cylinder-Pump Matching Chart located in the 'Yellow Pages'.

Page: **276**

Piston Stroke (mm)	Dimensions (mm)																	Model Number
	A	B	C	D	E	F	H	J	L	M	N	P	Q	R	S	T	(kg)	
25,4	383	480	30	35	37	-	550	416	163	-	140	111	-	-	8,4	-	6,2	P-39
25,4	391	487	30	35	47	-	550	424	163	-	140	111	-	-	8,4	-	7,1	P-77
25,4	428	511	30	35	55	-	579	460	195	-	150	121	42	-	8,4	74	10,7	P-80¹⁾
25,4	428	511	30	35	55	-	579	460	195	-	150	121	42	-	8,4	74	14,1	P-801
25,4	428	510	30	35	55	70	579	460	195	-	150	121	38	-	8,4	74	11,8	P-84³⁾
38,1	210	308	163	320	195	-	671	25	270	175	650	92	-	-	80	-	27,7	P-462
38,1	210	308	163	320	195	-	671	25	270	175	650	92	89	68	80	-	27,7	P-464³⁾