

Photocontrol - NIGHTFOX Top Lens Stem and Swivel Mount Electronic Photocontrol, 120-277 V

Item EK4736S



PRODUCT DESCRIPTION

NIGHTFOX electronic photocontrols permanently install on outdoor electrical boxes or outdoor lighting fixtures. Ideal for LED fixtures with long-life expectations. 1/2"-14 NPSM threaded stem fits standard outlet boxes and wall packs with a minimum installation hole size of 7/8" diameter. Come with 9" wire leads.

FEATURES

- ▶ Non-drift silicon light sensor with IR filter
- ▶ DC relay with zero-crossing circuitry for extended life
- ▶ Conformal coated PCB
- ▶ 15-year design life
- ▶ Exceeds 10,000 ON/OFF switching cycles
- ▶ Fail ON mode
- ▶ Ideal for single or multifixture HID and LED installations (up to 1,650 W @ 277 VAC)
- ▶ 255 J MOV surge protection element
- ▶ 1/2"-14 NPSM threaded stem fits standard outlet boxes and wall packs for a minimum installation hole size of 7/8 inch diameter
- ▶ #18 AWG wire leads

APPLICATIONS

- ▶ Outdoor Lighting Control

TECHNICAL DATA

General

Model Number	EK4736S
Description	NIGHTFOX Top Lens Stem and Swivel Mount Electronic Photocontrol, 120-277 V
UPC Code	078275146310
Brand	Intermatic
Country of Origin (Intermatic)	MEXICO
Warranty Period	8-Year limited

Control Specifications

Sensor Time Delay	Instant ON; 2 sec to 5 sec OFF
Photocell Type	Silicon Diode
Photo Control Switch Type	Relay
Fail Mode	ON
Activation On	1.5 fc
Activation Off	4.5 fc
Photocontrol Type	Electronic
Application Compatibilities	LED; Incandescent; HID
Photocontrol Style	Stem and Swivel Mount
Photocontrol Sensor Location	Top

Dimensions

Product Height (in)	5.625
Product Height (mm)	142.9
Product Width (in)	1.3125

Product Width (mm)	33.3
Product Depth (in)	1.25
Product Depth (mm)	31.8
Wire Lead Length (in)	6
Wire Lead Length (mm)	152.4
Wire Size Max	#18 AWG

Material Specifications

Color	Gray
Cover Color	Gray
Housing Material	Polycarbonate

Load Ratings

Tungsten Range(s)	1000 W
Ballast Fluorescent Ranges	1800 VA
Electronic Ballast Load Ratings Ranges	6 A, 120-277 VAC, 50/60 Hz

Electrical Specifications

Wiring Option	Wire leads
Input Voltage Range(s)	120-277 VAC, 50/60 Hz (Nominal Voltage)
Operating Voltage Range(s)	102-305 VAC
Surge Protection Technology	255 J MOV, 5,000 A Surge

Packaging

Shipping Weight (lbs)	0.28
Unit Carton Dimensions (H x W x D) in	4.875 x 3 x 1.75 in

Operating Specifications

Expected Lifetime (Years)	15
Expected Lifetime (Operations)	10000

Environmental Specifications

Temperature (operation)	-40°C..70°C
Usage Environments	Outdoor

Standards and Certifications

UL Certification	cULus
Other Certifications and Compatibilities	Title 20; Ansi C136.24; Green Energy +
California Proposition 65	DEHP
RoHS Certification	Y

ACCESSORIES



6LV1352
Light Shield Accessory for EK4036S, EK4436SM, K4000 Series Button Photocontrols



K43-WP-KIT
Wall Plate Kit for EK4036S, K4000 Series Button Photocontrols



LGLBL
Lens Sticker Accessory for EK4000 & K4000 Series Photocontrols



Zero-Crossing Technology Drives Long-Lasting Intermatic Solutions

Ensure your next lighting installation is designed to last for the long haul with reliable lighting controls from Intermatic. Select Intermatic timers, photocontrols and occupancy sensors include innovative zero-crossing technology, which helps minimize the damaging effects of high inrush current events.

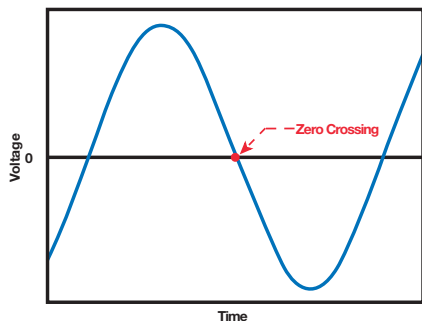

What is Zero Crossing?

Zero Crossing refers to the relay switching technology found in a variety of high-performance Intermatic controls. These models are designed to trigger load switching when AC voltage passes the zero mark rather than when operating current is near its peak.

Without this built-in technology, lighting controls can face severe high inrush transients that are up to 100 times the recommended operating level. Over time, this can damage or even completely destroy controls.

Key to Preventing Damage

Zero-crossing technology helps lighting controls match the long lifespan of new LED lighting systems. By taking a proactive approach and confirming lighting controls are compatible with LED bulbs, you can avoid maintenance issues and unexpected replacement costs down the road.

Finding the Right Match

Intermatic has a strong lineup of LED-rated controls that are UL-certified and designed to fit a wide range of applications. From outdoor billboards and parking lot lights to indoor offices and hydroponic applications, our zero-crossing solutions have you covered.

MEET OUR TEAM OF ZERO-CROSSING SOLUTIONS

ET2000 Series Basic+ Electronic Time Switches:

The ET2000 Series offers an easy-to-use interface and detailed scheduling options to match nearly any application. With up to 96 ON/OFF events and 50 holiday blocks, it's a robust digital control that fits seamlessly into existing Intermatic enclosures. The unit's 100-hour capacitor also helps safeguard against power outages.

NightFox™ Pro Series:

Balancing efficiency, durability and functionality, NightFox Pro Series provides municipalities, utilities and co-ops a new level of customization with photocontrols. Tested at full load to 5 k, 10 k, and 15 k ON/OFF cycles with NEMA 410 inrush load abilities, they help meet a wide variety of application needs and budgets without sacrificing quality. They're a top-level photocontrol solution that's tested and warranted to match the life expectancy of LED fixtures.

NightFox™ Series:

Similar to the NightFox Pro Series, standard NightFox Series photocontrols are designed to match the long life of LED and induction lighting fixtures. They come with a 10- to 20-year service life expectancy and include solid-state light sensors and relays that feature zero-crossing technology for more

precise control. Locking type models in two voltage ranges, 120-277 V or 347-480 V, which makes it easy to accommodate any power supply configuration.

talento smart™ Time Switch:

The new talento smart product family was developed with electricians at its core. Its compact DIN rail design streamlines the installation process while Bluetooth® connectivity and the intuitive talento smart mobile app makes it easy to save time programming the device. Zero-crossing technology, 365-day scheduling and automatic Astronomic dusk-to-dawn functionality, it's the perfect digital time switch to manage energy costs in both commercial and residential settings.

Commercial Grade Occupancy Sensors

Intermatic Commercial Grade Occupancy Sensors help installers save on energy costs while adding a level of convenience and security to all types of facilities. Choose from both in-wall and ceiling mount styles, as well as PIR or Dual Technology solutions, to match your project's needs. Our Occupancy Sensors are compatible with incandescent, fluorescent, CFL and LED fixtures, and include zero-crossing technology to maximize the lifespan and performance of fixtures.

- In-Wall Mount Models:
IOS-DSR/DOV/DDR,
IOS-DOV-DT-WH
- Ceiling Mount Models:
IOS-CMP-DT-U,
IOS-HB-U, IOS-CMP-U

Contact your Intermatic sales representative today to learn more about our full catalog of zero-crossing solutions.



MODEL EK4000 Series

Installation and Setup Instructions

⚠ WARNING Risk of Fire or Electric Shock

- Disconnect power at the circuit breaker(s) or disconnect switch(es) before beginning installation or servicing.
- Do NOT use the OFF state of the photocontrol for equipment servicing.

NOTICE

- DO NOT MOUNT WITH THE WIRES FACING UP.

Ratings:

Input Voltage	120-277 V Photocontrols	347 V Photocontrols	480 V Photocontrols
Load Ratings	Tungsten: 1000 W Ballast: 1800 VA Electronic Ballast: 6 A	Tungsten: 1000 W Ballast: 1800 VA Electronic Ballast: 2 A	Tungsten: 1000 W Ballast: 1800 VA Electronic Ballast: 0.35 A*

*Tested with 150 W 480 V LED driver with 120 A_{pk} /100µs In-rush current

Installation:

1. Make sure to turn the power off at the breaker before installation.
2. Mount with an approved outdoor junction box or fixture using the included gasket and nut. (See photo)
DO NOT MOUNT WITH THE WIRES FACING UP OR ON THE BOTTOM OF AN ENCLOSURE.
4. Orient the lens of the photocontrol so it faces NORTH and away from artificial light sources that may cause the load to turn off at night.
5. See diagram below for wiring.
6. When all wiring is complete, you can turn the breaker back on to restore power to the photocontrol.
7. Test the unit by covering the lens of the photocontrol with a leather glove or similar. The photocontrol should react to a change within 30 seconds.

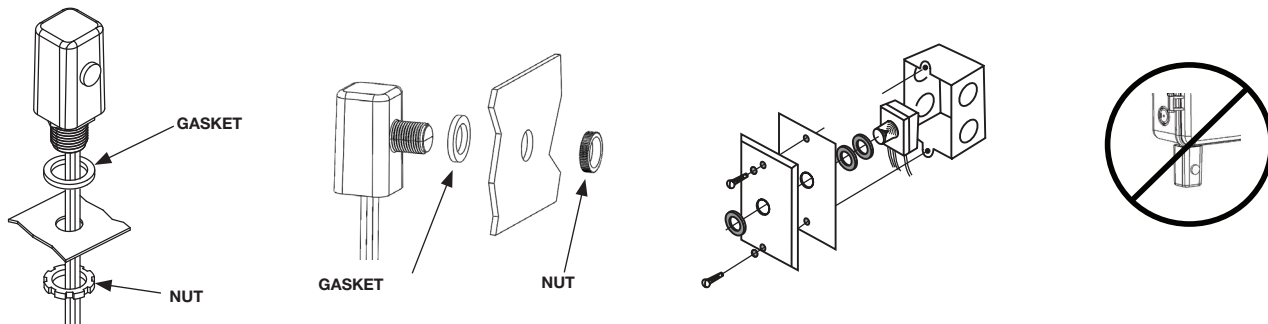
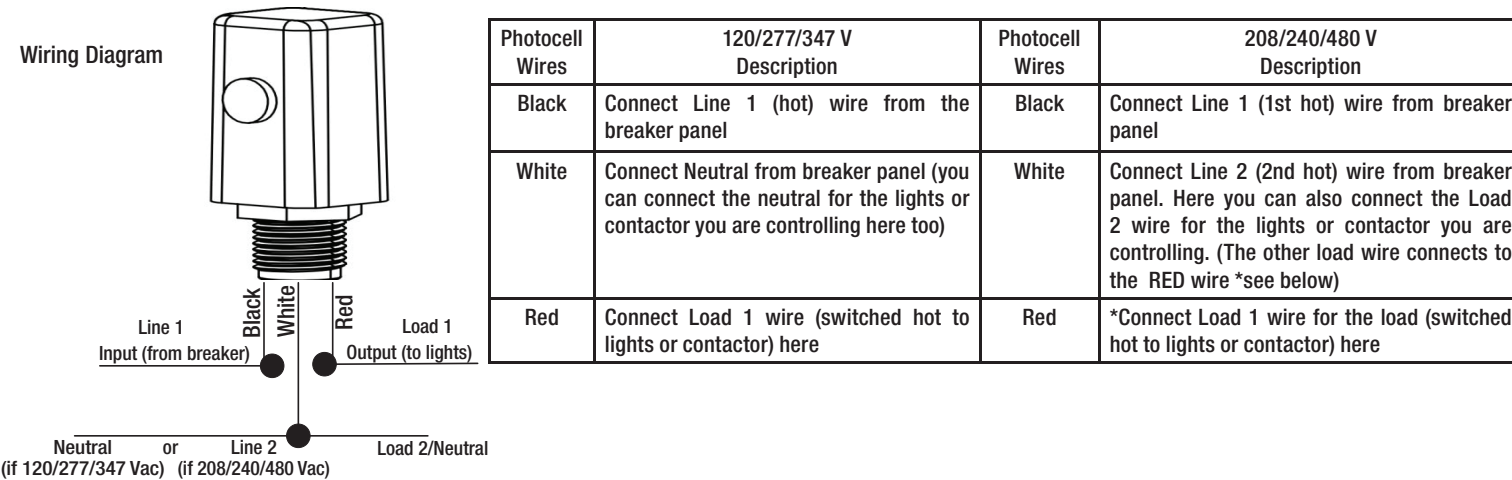

Included Accessories:

- Metal Light Shield (22LG0120) Qty 1 - Stem Mount and Stem & Swivel Mount Models
- Light Shield Plastic Dome (6LV1352) Qty 1 - Button Style Models
- Self-Adhesive Round Labels (LGLBL) - All Models

PRO TIP: Use when there is a high amount of incident light on the photocontrol from artificial light sources that may interfere with proper operation of photocontrol.

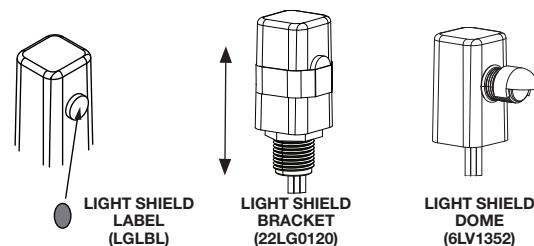

MODÈLE Série EK4000

Instructions d'installation et de configuration

⚠ AVERTISSEMENT Risque d'incendie ou d'électrocution

- Débrancher l'alimentation au niveau des disjoncteurs ou des sectionneurs avant de procéder à l'installation ou à l'entretien.
- Ne PAS utiliser l'état ARRÊT de la commande photo-électronique pour travailler sur le matériel.

AVIS

- NE PAS MONTER AVEC LES FILS VERS LE HAUT.

Valeurs nominales :

Tension d'entrée	120-277 V Photocontrôles	347 V Photocontrôles	480 V Photocontrôles
Capacités de charge	Tungstène: 1000 W Ballast: 1800 VA Ballast électronique: 6 A	Tungstène: 1000 W Ballast: 1800 VA Ballast électronique: 2 A	Tungstène: 1000 W Ballast: 1800 VA Ballast électronique: 0.35 A*

*Testé avec un pilote DEL 150 W 480 V avec un courant d'appel de 120 A_{pk} /100 µs

Installation :

1. Veiller à couper l'alimentation au niveau du disjoncteur avant de procéder à l'installation.
2. Effectuer le montage à l'aide d'une boîte de dérivation ou un luminaire homologués pour l'extérieur à l'aide du joint et de l'écrou fournis (Voir photo)
NE PAS MONTER AVEC LES FILS ORIENTÉS VERS LE HAUT OU VERS LE BAS D'UN BÔITIER.
4. Orienter la lentille de la commande photo-électronique de sorte qu'elle soit orientée vers le NORD et à l'écart de sources de lumière artificielle susceptibles de provoquer l'ouverture du circuit de charge la nuit.
5. Voir le schéma de câblage ci-dessous.
6. Une fois le câblage terminé, il sera possible de remettre le disjoncteur en marche pour rétablir l'alimentation dans la commande photo-électronique.
7. Pour vérifier le fonctionnement, couvrir la lentille de la commande photo-électronique avec un gant de cuir ou un produit similaire. La commande photo-électronique doit réagir à ce changement au bout de 30 secondes.

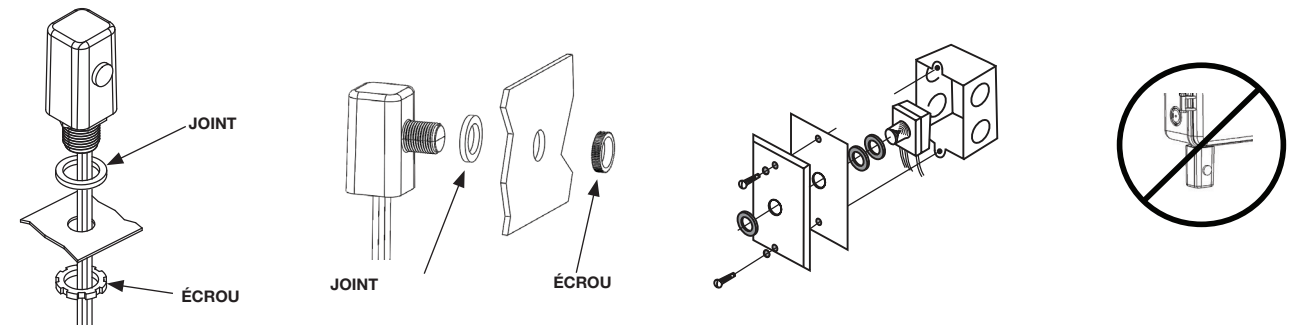
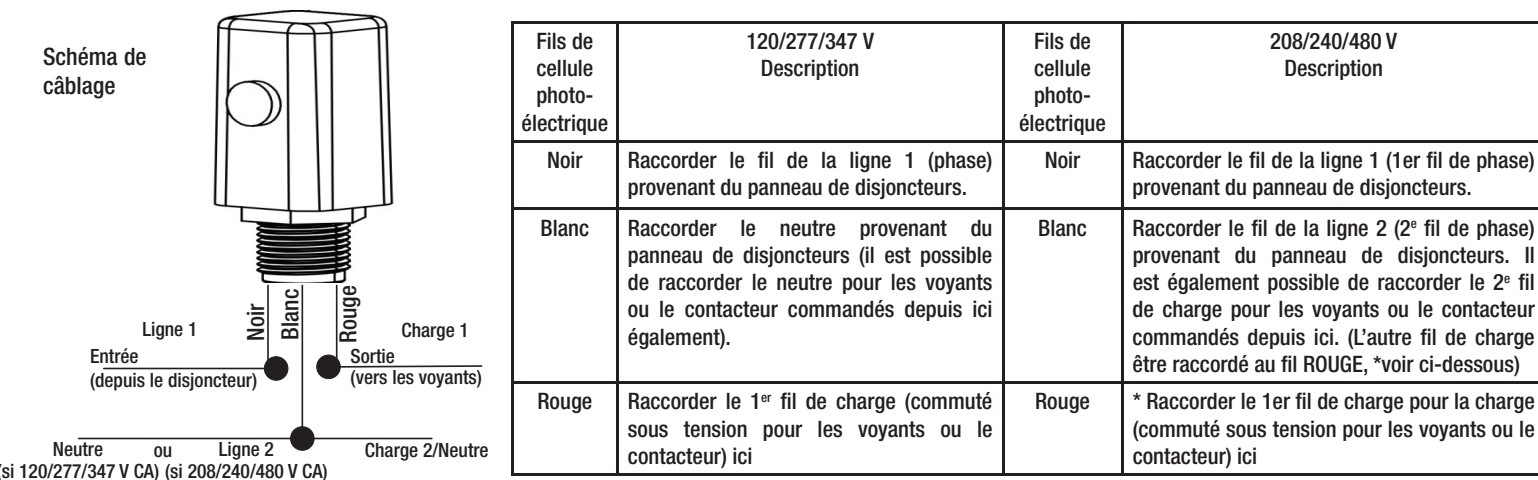

Accessoires fournis :

- 1 écran pare-lumière en métal (22LG0120), pour les modèles avec montage sur tige ou sur tige et support pivotant
- 1 dôme pare-lumière en plastique (6LV1352), pour les modèles à bouton
- 5 étiquettes auto-adhésives rondes (LGLBL), tous les modèles

CONSEIL DE PROFESSIONNELS : À utiliser si la commande photo-électronique est exposée à une grande quantité de lumière incidente provenant de sources de lumière artificielle susceptibles de nuire à son bon fonctionnement.

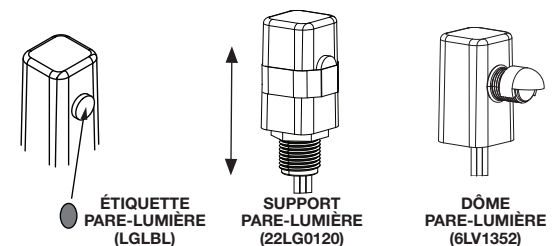

Instalación e instrucciones de configuración

⚠️ ADVERTENCIA *Riesgo de incendio o descarga eléctrica*

- Desconecte la alimentación eléctrica de los disyuntores o desconecte los interruptores antes de comenzar la instalación o el mantenimiento.
- NO use el estado OFF (apagado) del control fotoelectrónico para realizar mantenimiento del equipo.

AVISO

- NO LO MONTE CON LOS CABLES HACIA ARRIBA.

Capacidades:

Voltaje de entrada	120-277 V Fotocontrols	347 V Fotocontrols	480 V Fotocontrols
Capacidades de carga	Tungsteno: 1000 W Balasto: 1800 VA Balasto electrónico: 6 A	Tungsteno: 1000 W Balasto: 1800 VA Balasto electrónico: 2 A	Tungsteno: 1000 W Balasto: 1800 VA Balasto electrónico: 0.35 A*

*Probado con controlador LED de 150 W 480 V, con corriente de irrupción de 120 A_{pk}/100 μs

Instalación:

1. Asegúrese de desconectar la alimentación eléctrica en el disyuntor antes de la instalación.
2. Monte con una caja de conexiones o luminaria aprobada para exteriores con la junta y la tuerca incluidas. (Ver foto)
NO MONTE CON LOS CABLES HACIA ARRIBA O EN LA PARTE INFERIOR DE UN RECINTO.
4. Oriente la lente del control fotoelectrónico de forma que apunte al NORTE y lejos de fuentes de luz artificiales que puedan provocar que la carga se apague por la noche.
5. Consulte el diagrama que aparece a continuación para ver el cableado.
6. Cuando todo el cableado esté completo, puede volver a activar el disyuntor para restablecer la alimentación eléctrica del control fotoelectrónico.
7. Para probar la unidad, cubra la lente del control fotoelectrónico con un guante de cuero o similar. El control fotoelectrónico debe reaccionar al cambio en el transcurso de 30 segundos.

Diagrama de cableado

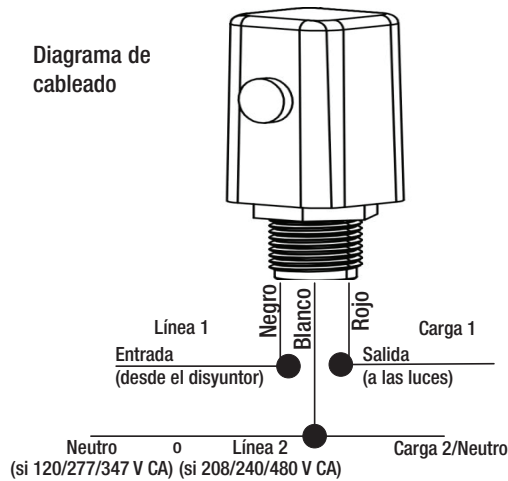

Cables de la fotocélula	120/277/347 V Descripción	Cables de la fotocélula	208/240/480 V Descripción
Negro	Conecte el cable de la línea 1 (caliente) desde el panel del disyuntor	Negro	Conecte el cable de la línea 1 (1.ª caliente) desde el panel del disyuntor
Blanco	Conecte el neutro desde el panel del disyuntor (también puede conectar el neutro para las luces o el contactor que esté controlando aquí)	Blanco	Conecte el cable de la línea 2 (2.ª caliente) desde el panel del disyuntor. Aquí también puede conectar el cable de carga 2 para las luces o el contactor que esté controlando. (El otro cable de carga se conecta al cable ROJO, *ver a continuación)
Rojo	Conecte aquí el cable de carga 1 (conmutado en caliente a las luces o el contactor)	Rojo	*Conecte aquí el cable de carga 1 para la carga (conmutado en caliente a las luces o al contactor)

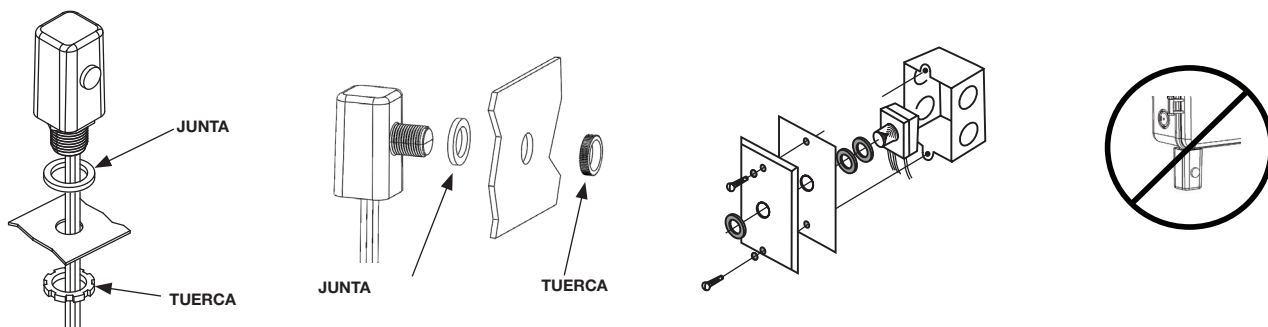

Accesorios incluidos:

- 1 pantalla de luz metálica (22LG0120): modelos de montaje en vástago y de montaje en vástago y giratorio
- 1 cúpula de plástico de pantalla de luz (6LV1352): modelos de botón
- etiquetas redondas autoadhesivas (LGLBL): todos los modelos

CONSEJO PROFESIONAL: Se debe usar donde hay una gran cantidad de luz incidente en el control fotoelectrónico proveniente de fuentes de luz artificiales que puedan interferir con el funcionamiento correcto del control fotoelectrónico.

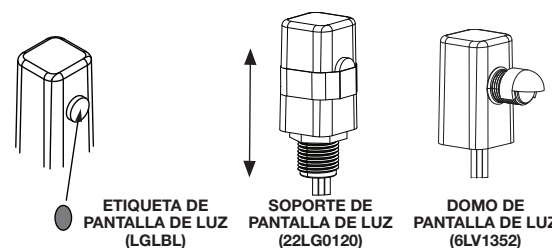

Warranty service is available by either (a) returning the product to the dealer from whom the unit was purchased or (b) completing a warranty claim online at www.intermatic.com. This warranty is made by: Intermatic Incorporated, Customer Service 1950 Innovation Way, Suite 300, Libertyville, IL 60048. For warranty service go to: <http://www.intermatic.com> or call 815-675-7000.

GARANTIE LIMITÉE

Ce service de garantie est disponible (a) en retournant le produit au vendeur auprès duquel l'unité a été achetée ou (b) en remplissant un formulaire en ligne de réclamation de garantie sur www.intermatic.com. Cette garantie est faite par : Intermatic Incorporated, Customer Service 1950 Innovation Way, Suite 300, Libertyville, IL 60048. Pour les services de garantie, accédez à la page suivante : <http://www.intermatic.com> ou appelez au 815-675-7000.

GARANTÍA LIMITADA

Este servicio de garantía está disponible mediante (a) la devolución del producto al proveedor al que se le compró la unidad; o (b) el llenado de una reclamación de garantía en línea en www.intermatic.com. Esta garantía la otorga: Intermatic Incorporated, Customer Service 1950 Innovation Way, Suite 300, Libertyville, IL 60048. Para obtener servicios de garantía, ingrese a: <http://www.intermatic.com> o llame al 815-675-7000.