



**True Union 2000 Standard Retrofit Ball Valves - Replaces Spears® "Regular Style" Valves**

**CPVC - Socket Ends (continued)**

| Size     | EPDM                  | Viton®                | Std Pk | Mstr Pk | Disc Code |
|----------|-----------------------|-----------------------|--------|---------|-----------|
| <b>4</b> | 3622RS-040C<br>797.68 | 3632RS-040C<br>886.31 | 1      | 0       | 611       |

**True Union Ball Valves (Regular Style)**



Socket/Threaded Style

Pressure Rating @ 73°F (23°C), Water  
 1/2" - 2" 235 psi  
 2-1/2" - 6" 150 psi  
 Flanged 150 psi  
 Maximum Service Temperature  
 CPVC = 200°F (93°C)  
 Temperature/Pressure De-ratings Apply  
 Rated for Vacuum Service  
 All Valves assembled with Silicone-Free, Water Soluble Lubricant.

6" Venturied Valves are 4" Ball Valves equipped with 4x6 End Connectors.

**CPVC**

| Size | EPDM | Viton® | Std Pk | Mstr Pk | Disc Code |
|------|------|--------|--------|---------|-----------|
|------|------|--------|--------|---------|-----------|

**Socket & Threaded Ends**

Threaded End Connectors available on request

|              |                     |                     |   |    |     |
|--------------|---------------------|---------------------|---|----|-----|
| <b>1/2</b>   | 2329-005C<br>71.79  | 2339-005C<br>79.80  | 1 | 18 | 232 |
| <b>3/4</b>   | 2329-007C<br>90.45  | 2339-007C<br>100.51 | 1 | 12 | 232 |
| <b>1</b>     | 2329-010C<br>107.65 | 2339-010C<br>119.62 | 1 | 8  | 232 |
| <b>1-1/4</b> | 2329-012C<br>171.15 | 2339-012C<br>190.23 | 1 | 8  | 232 |
| <b>1-1/2</b> | 2329-015C<br>180.76 | 2339-015C<br>200.85 | 1 | 8  | 232 |
| <b>2</b>     | 2329-020C<br>241.77 | 2339-020C<br>277.90 | 1 | 4  | 232 |

**Socket Ends**

|              |                      |                      |   |   |     |
|--------------|----------------------|----------------------|---|---|-----|
| <b>2-1/2</b> | 2322-025C<br>514.91  | 2332-025C<br>572.10  | 1 | 0 | 232 |
| <b>3</b>     | 2322-030C<br>602.06  | 2332-030C<br>668.98  | 1 | 0 | 232 |
| <b>4</b>     | 2322-040C<br>1090.95 | 2332-040C<br>1212.17 | 1 | 0 | 232 |

**Socket Venturied Ends**

|                    |                      |                      |   |   |     |
|--------------------|----------------------|----------------------|---|---|-----|
| <b>6 VENTURIED</b> | 2322-060C<br>1814.86 | 2332-060C<br>1883.05 | 1 | 0 | 233 |
|--------------------|----------------------|----------------------|---|---|-----|

**Threaded Ends**

|              |                      |                      |   |   |     |
|--------------|----------------------|----------------------|---|---|-----|
| <b>2-1/2</b> | 2321-025C<br>514.91  | 2331-025C<br>572.10  | 1 | 0 | 232 |
| <b>3</b>     | 2321-030C<br>602.06  | 2331-030C<br>668.98  | 1 | 0 | 232 |
| <b>4</b>     | 2321-040C<br>1090.95 | 2331-040C<br>1212.17 | 1 | 0 | 232 |

**Flanged Ends**

|              |                     |                     |   |   |     |
|--------------|---------------------|---------------------|---|---|-----|
| <b>1/2</b>   | 2323-005C<br>121.82 | 2333-005C<br>124.45 | 6 | 0 | 232 |
| <b>3/4</b>   | 2323-007C<br>149.34 | 2333-007C<br>155.56 | 5 | 0 | 232 |
| <b>1</b>     | 2323-010C<br>170.99 | 2333-010C<br>181.50 | 5 | 0 | 232 |
| <b>1-1/4</b> | 2323-012C<br>255.45 | 2333-012C<br>264.41 | 2 | 0 | 232 |
| <b>1-1/2</b> | 2323-015C<br>281.00 | 2333-015C<br>290.33 | 3 | 0 | 232 |
| <b>2</b>     | 2323-020C<br>391.02 | 2333-020C<br>465.68 | 2 | 0 | 232 |
| <b>2-1/2</b> | 2323-025C<br>693.31 | 2333-025C<br>832.19 | 1 | 0 | 232 |

**CPVC (continued)**

| Size | EPDM | Viton® | Std Pk | Mstr Pk | Disc Code |
|------|------|--------|--------|---------|-----------|
|------|------|--------|--------|---------|-----------|

**Flanged Ends**

|          |                      |                      |   |   |     |
|----------|----------------------|----------------------|---|---|-----|
| <b>3</b> | 2323-030C<br>1013.93 | 2333-030C<br>1037.03 | 1 | 0 | 232 |
| <b>4</b> | 2323-040C<br>1778.24 | 2333-040C<br>1849.36 | 1 | 0 | 232 |

**Flanged Venturied Ends**

|                    |                      |                      |   |   |     |
|--------------------|----------------------|----------------------|---|---|-----|
| <b>6 VENTURIED</b> | 2323-060C<br>2756.35 | 2333-060C<br>2851.87 | 1 | 0 | 233 |
|--------------------|----------------------|----------------------|---|---|-----|

**Thermoplastic Valves**  
 True Union 2000 Standard Retrofit Ball Valves - Replaces Spears® "Regular Style" Valves & True Union Ball Valves (Regular Style)



**True Union 2000 Standard Retrofit Ball Valves - Replaces Spears® "Regular Style" Valves**



Standard Valve

Complete replacement valve for older Spears® 2300 Series Regular True Union Ball Valves. See separate catalog listing for replacement of other brand valves.

Retrofit valve consists of Spears® Standard True Union 2000 Ball Valve supplied with factory installed extended-socket end connectors. Simply cut out old valve to specified dimensions and install Retrofit Valve end connectors.

Pressure Rating @ 73°F (23°C), Water  
 1/2" - 2" 235 psi  
 2-1/2" - 4" 150 psi

All Valves Assembled with Silicone-Free, Water Soluble Lubricant

Suitable for Vacuum Service

Retrofit End Connector Sets without valve are also available - See Ball Valve Accessories & Repair Kits

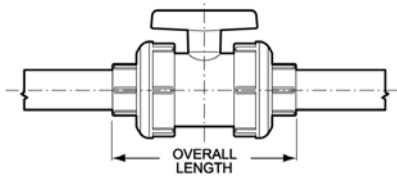

BALL VALVE FOR REPLACEMENT



PIPE LAYING LENGTH AFTER CUTTING

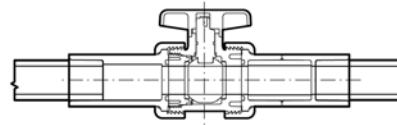

TRUE UNION 2000 STANDARD BALL VALVE INSTALLED WITH RETROFIT KIT

| Size | 1/2    | 3/4   | 1       | 1-1/4 | 1-1/2  | 2       | 2-1/2 | 3       | 4       |
|------|--------|-------|---------|-------|--------|---------|-------|---------|---------|
| L    | 5-5/16 | 6-1/4 | 6-11/16 | 7-1/8 | 8-3/16 | 8-15/16 | 12    | 12-1/16 | 13-3/16 |

**PVC - Socket Ends**

| Size  | EPDM                 | Viton®               | Std Pk | Mstr Pk | Disc Code |
|-------|----------------------|----------------------|--------|---------|-----------|
| 1/2   | 3622RS-005<br>37.78  | 3632RS-005<br>42.02  | 1      | 18      | 608       |
| 3/4   | 3622RS-007<br>44.68  | 3632RS-007<br>49.70  | 1      | 18      | 608       |
| 1     | 3622RS-010<br>53.22  | 3632RS-010<br>59.28  | 1      | 12      | 608       |
| 1-1/4 | 3622RS-012<br>73.61  | 3632RS-012<br>93.96  | 1      | 8       | 608       |
| 1-1/2 | 3622RS-015<br>88.68  | 3632RS-015<br>98.44  | 1      | 8       | 608       |
| 2     | 3622RS-020<br>117.02 | 3632RS-020<br>128.84 | 1      | 4       | 608       |
| 2-1/2 | 3622RS-025<br>224.15 | 3632RS-025<br>304.76 | 1      | 0       | 609       |
| 3     | 3622RS-030<br>296.53 | 3632RS-030<br>329.47 | 1      | 0       | 609       |
| 4     | 3622RS-040<br>500.87 | 3632RS-040<br>556.71 | 1      | 0       | 609       |

**CPVC - Socket Ends**

| Size  | EPDM                  | Viton®                | Std Pk | Mstr Pk | Disc Code |
|-------|-----------------------|-----------------------|--------|---------|-----------|
| 1/2   | 3622RS-005C<br>49.86  | 3632RS-005C<br>55.44  | 1      | 18      | 610       |
| 3/4   | 3622RS-007C<br>62.82  | 3632RS-007C<br>69.82  | 1      | 18      | 610       |
| 1     | 3622RS-010C<br>74.79  | 3632RS-010C<br>83.10  | 1      | 12      | 610       |
| 1-1/4 | 3622RS-012C<br>118.90 | 3632RS-012C<br>132.15 | 1      | 8       | 610       |
| 1-1/2 | 3622RS-015C<br>125.55 | 3632RS-015C<br>139.51 | 1      | 8       | 610       |
| 2     | 3622RS-020C<br>167.94 | 3632RS-020C<br>193.05 | 1      | 4       | 610       |
| 2-1/2 | 3622RS-025C<br>376.49 | 3632RS-025C<br>418.30 | 1      | 0       | 611       |
| 3     | 3622RS-030C<br>440.22 | 3632RS-030C<br>489.16 | 1      | 0       | 611       |
| 4     | 3622RS-040C<br>797.68 | 3632RS-040C<br>886.31 | 1      | 0       | 611       |

**True Union Ball Valves (Regular Style)**



Socket/Threaded Style



Flanged Style

Pressure Rating @ 73°F (23°C), Water  
 1/2" - 2" 235 psi  
 2-1/2" - 6" 150 psi  
 Flanged 150 psi  
 Maximum Service Temperature  
 PVC = 140°F (60°C)  
 CPVC = 200°F (93°C)  
 Temperature/Pressure De-ratings Apply  
 Rated for Vacuum Service  
 All Valves assembled with Silicone-Free, Water Soluble Lubricant.

6" Venturied Valves are 4" Ball Valves equipped with 4x6 End Connectors.

**PVC**

| Size | EPDM              | Viton®            | Std Pk | Mstr Pk | Disc Code |
|------|-------------------|-------------------|--------|---------|-----------|
| 1/2  | 2329-005<br>54.37 | 2339-005<br>60.50 | 1      | 18      | 230       |
| 3/4  | 2329-007<br>64.31 | 2339-007<br>71.57 | 1      | 12      | 230       |
| 1    | 2329-010<br>76.61 | 2339-010<br>85.33 | 1      | 8       | 230       |

**Socket & Threaded Ends**

**PVC (continued)**

| Size  | EPDM               | Viton®             | Std Pk | Mstr Pk | Disc Code |
|-------|--------------------|--------------------|--------|---------|-----------|
| 1-1/4 | 2329-012<br>105.97 | 2339-012<br>135.26 | 1      | 8       | 230       |
| 1-1/2 | 2329-015<br>127.68 | 2339-015<br>141.70 | 1      | 8       | 230       |
| 2     | 2329-020<br>168.44 | 2339-020<br>185.49 | 1      | 4       | 230       |

**Socket & Threaded Ends**