

GRATING: 19W4 GALVANIZED  
BAR GRATING

# VERTICAL STEEL RETENTION BASIN - VSRB-IN-4

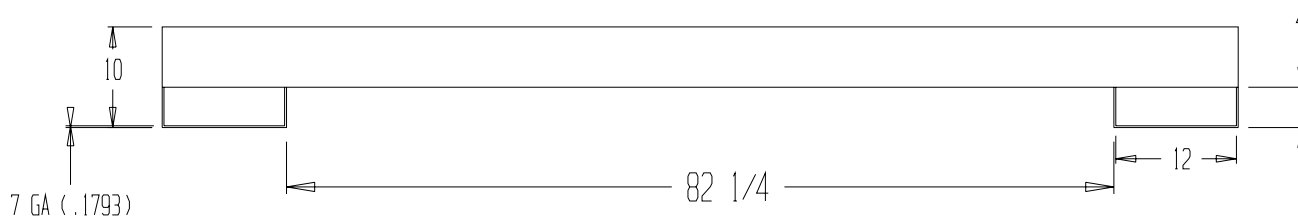
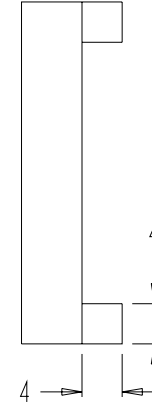
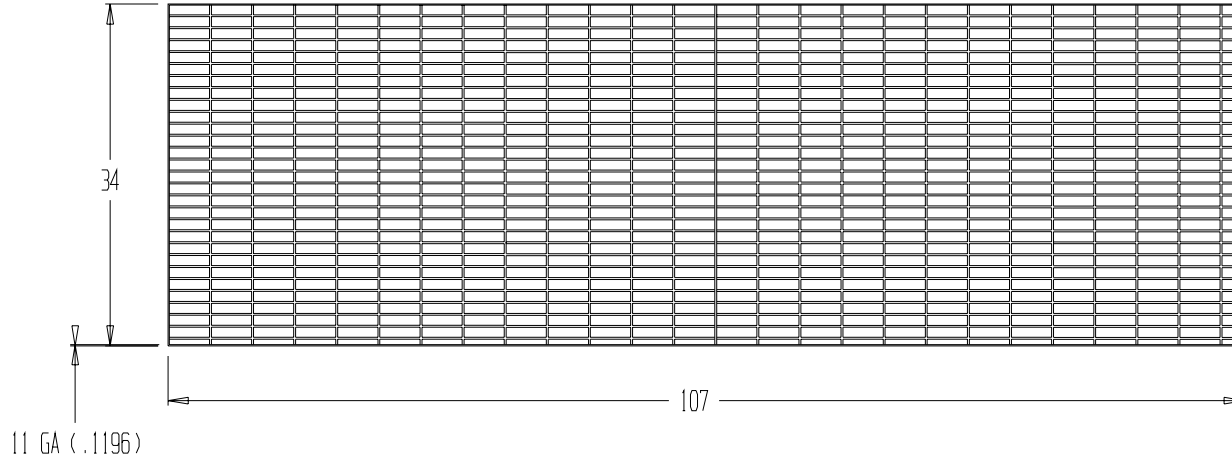

LEAD TIME WILL START UPON  
RECEIPT OF SIGNED APPROVAL  
DRAWING

## STANDARD FEATURES

MODEL NUMBER: VSRB-IN-4  
STORAGE CAPACITY: 4 X 55-GALLON DRUMS  
LOAD CAPACITY: 2400 LBS.  
SHIPPING WEIGHT: 380 LBS.  
DIMENSIONS: 107" L X 34" D X 10" H

## SPECIAL FEATURES

NONE

\*\*SPECIAL UNITS ARE NON-RETURNABLE  
\*AVAILABLE AT ADDITIONAL COSTS

## APPROVAL

I, the undersigned, hereby approve this print  
 As drawn       As marked  
 This includes my approval of design & dimensions.  
 Signed: \_\_\_\_\_  
 Date: \_\_\_\_\_

DISTRIBUTOR'S NAME:		P.O.#: _
<b>VESTIL MANUFACTURING</b>		W.O.#: _
DRAWN BY: K. WENGER	DATE: 07/02/07	SALES: _
REFERENCE:		DRWG./FILE NAME:
-	SCALE: 1:20	VSRB-IN-4